

Soils Map

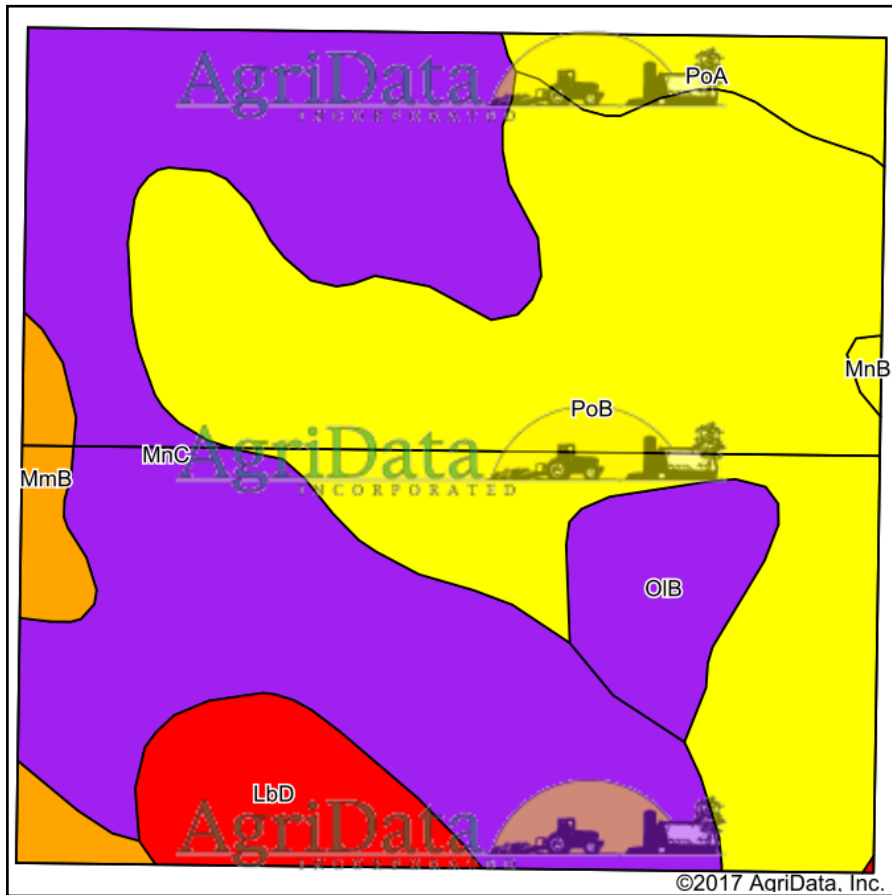

Soils data provided by USDA and NRCS.

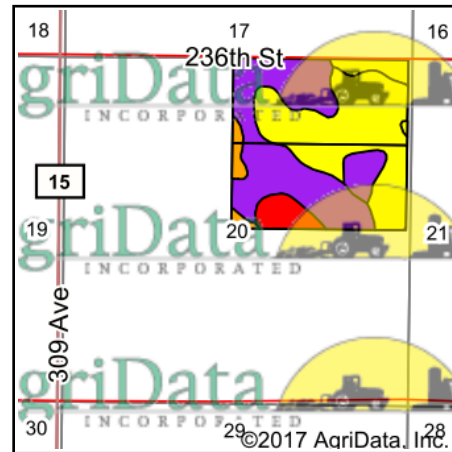

State: **South Dakota**
 County: **Lyman**
 Location: **20-106N-76W**
 Township: **Northwest Lyman**
 Acres: **159.13**
 Date: **9/28/2017**

Maps Provided By:



© AgriData, Inc. 2017

www.AgriDataInc.com

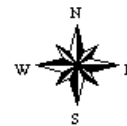

Area Symbol: SD085, Soil Area Version: 17

Code	Soil Description	Acres	Percent of field	PI Legend	Non-Irr Class *c	Irr Class *c	Productivity Index	State Productivity Index
PoB	Promise clay, 3 to 6 percent slopes	66.08	41.5%		IIle	IIle	64	43
MnC	Boro-Millboro silty clays, 6 to 9 percent slopes	63.99	40.2%		IVe	IVe	56	38
LbD	Lakoma-Okaton silty clays, 6 to 15 percent slopes	9.25	5.8%		IVe	IVe	33	22
OIB	Opal clay, 3 to 6 percent slopes	8.17	5.1%		IIle	IIle	60	40
PoA	Promise clay, 0 to 3 percent slopes	6.29	4.0%		IIIs	IIIs	68	46
MmB	Millboro silty clay, 3 to 6 percent slopes	4.94	3.1%		IIle	IIle	79	53
MnB	Boro-Millboro silty clays, 3 to 6 percent slopes	0.41	0.3%		IIle	IIle	68	46
Weighted Average							59.4	40.1

*c: Using Capabilities Class Dominant Condition Aggregation Method

Soils data provided by USDA and NRCS.

Soils Map

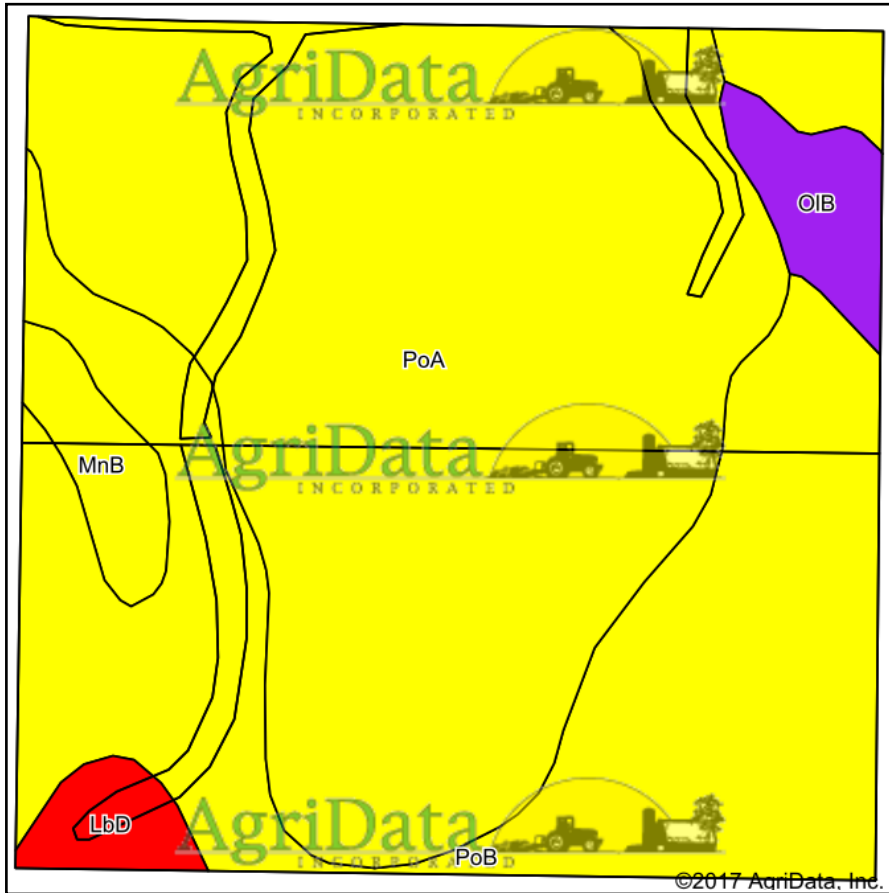

Soils data provided by USDA and NRCS.

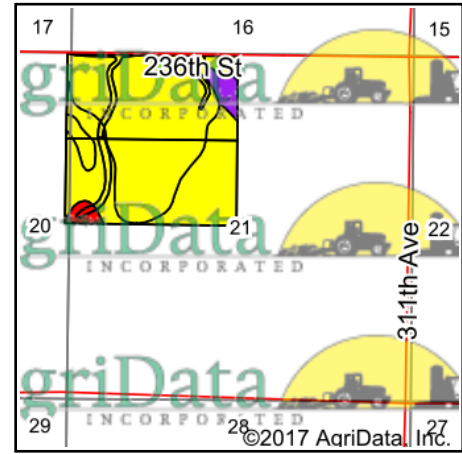

State: **South Dakota**
 County: **Lyman**
 Location: **21-106N-76W**
 Township: **Northwest Lyman**
 Acres: **155.51**
 Date: **9/28/2017**

Maps Provided By:

 CUSTOMIZED ONLINE MAPPING
 © AgriData, Inc. 2017 www.AgriDataInc.com



Area Symbol: SD085, Soil Area Version: 17

Code	Soil Description	Acres	Percent of field	PI Legend	Non-Irr Class *c	Irr Class *c	Productivity Index	State Productivity Index
PoA	Promise clay, 0 to 3 percent slopes	89.17	57.3%		III _s	III _s	68	46
PoB	Promise clay, 3 to 6 percent slopes	53.94	34.7%		III _e	III _e	64	43
OIB	Opal clay, 3 to 6 percent slopes	4.82	3.1%		III _e	III _e	60	40
MnB	Boro-Millboro silty clays, 3 to 6 percent slopes	4.38	2.8%		III _e	III _e	68	46
LbD	Lakoma-Okaton silty clays, 6 to 15 percent slopes	3.20	2.1%		IV _e	IV _e	33	22
Weighted Average							65.6	44.3

*c: Using Capabilities Class Dominant Condition Aggregation Method

Soils data provided by USDA and NRCS.