

Aerial Map

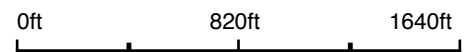

©2021 AgriData, Inc.

Map Center: 43° 54' 45.1, -99° 39' 19.56



12-105N-74W
Lyman County
South Dakota



6/8/2021

Maps Provided By:

CUSTOMIZED ONLINE MAPPING
© AgriData, Inc. 2021 www.AgriDataInc.com

Field borders provided by Farm Service Agency as of 5/21/2008.

Soils Map

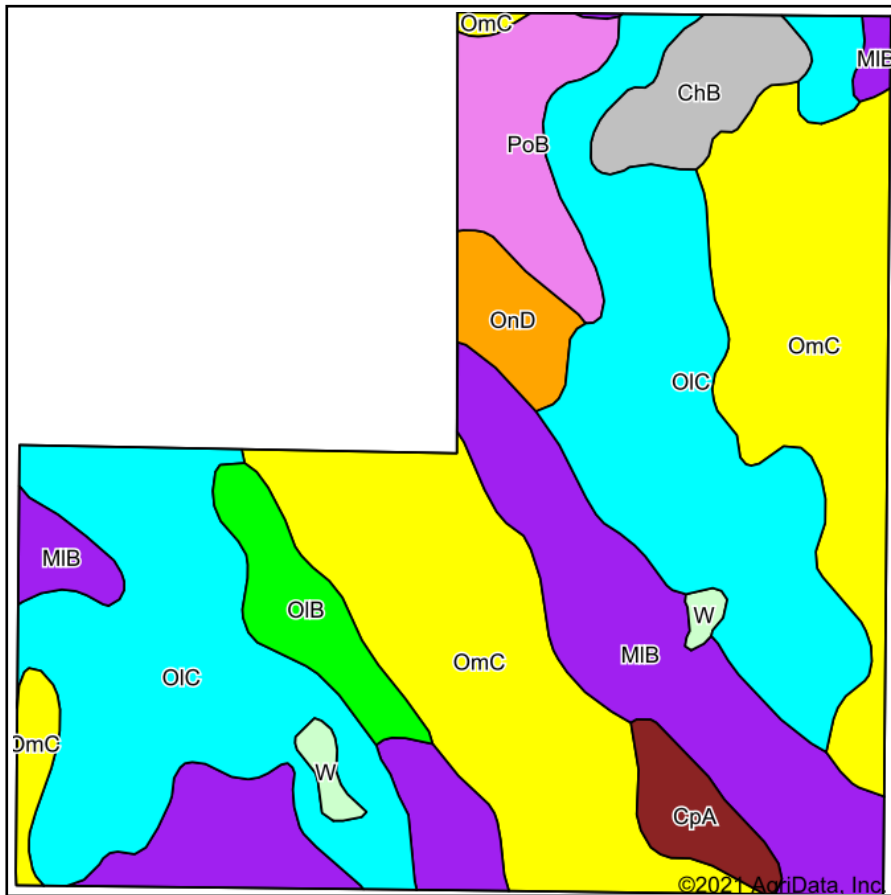

Soils data provided by USDA and NRCS.

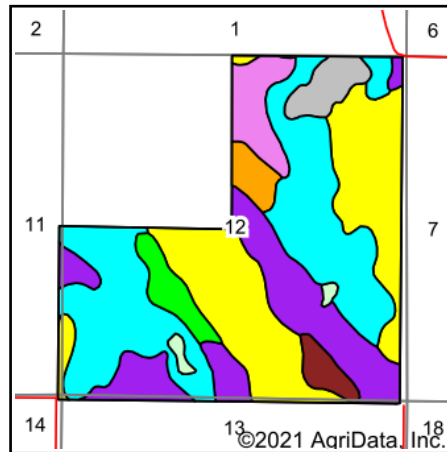

State: **South Dakota**
 County: **Lyman**
 Location: **12-105N-74W**
 Township: **Rex**
 Acres: **477.95**
 Date: **6/8/2021**



Area Symbol: SD085, Soil Area Version: 21

Code	Soil Description	Acres	Percent of field	PI Legend	Non-Irr Class *c	Irr Class *c	Productivity Index	
OIC	Opal clay, 6 to 9 percent slopes	162.47	34.0%		IVe	IVe	49	
OmC	Opal-Chantier clays, 2 to 9 percent slope	142.89	29.9%		IVe		29	
MIB	Millboro silty clay loam, 3 to 6 percent slopes	88.96	18.6%		IIe	IIe	82	
PoB	Promise clay, 3 to 6 percent slopes	24.32	5.1%		IIIe	IIIe	64	
ChB	Chantier clay, 2 to 9 percent slopes	16.79	3.5%		VIIs		7	
OIB	Opal clay, 3 to 6 percent slopes	16.65	3.5%		IIIe	IIIe	60	
OnD	Opal-Sansarc clays, 6 to 15% slopes	11.44	2.4%		VIe	VIe	38	
CpA	Capa silt loam, 0 to 6 percent slopes	10.40	2.2%		VIIs	VIIs	11	
W	Water	4.03	0.8%		VIII		0	
Weighted Average								47.3

*c: Using Capabilities Class Dominant Condition Aggregation Method
 Soils data provided by USDA and NRCS.

Topography Map

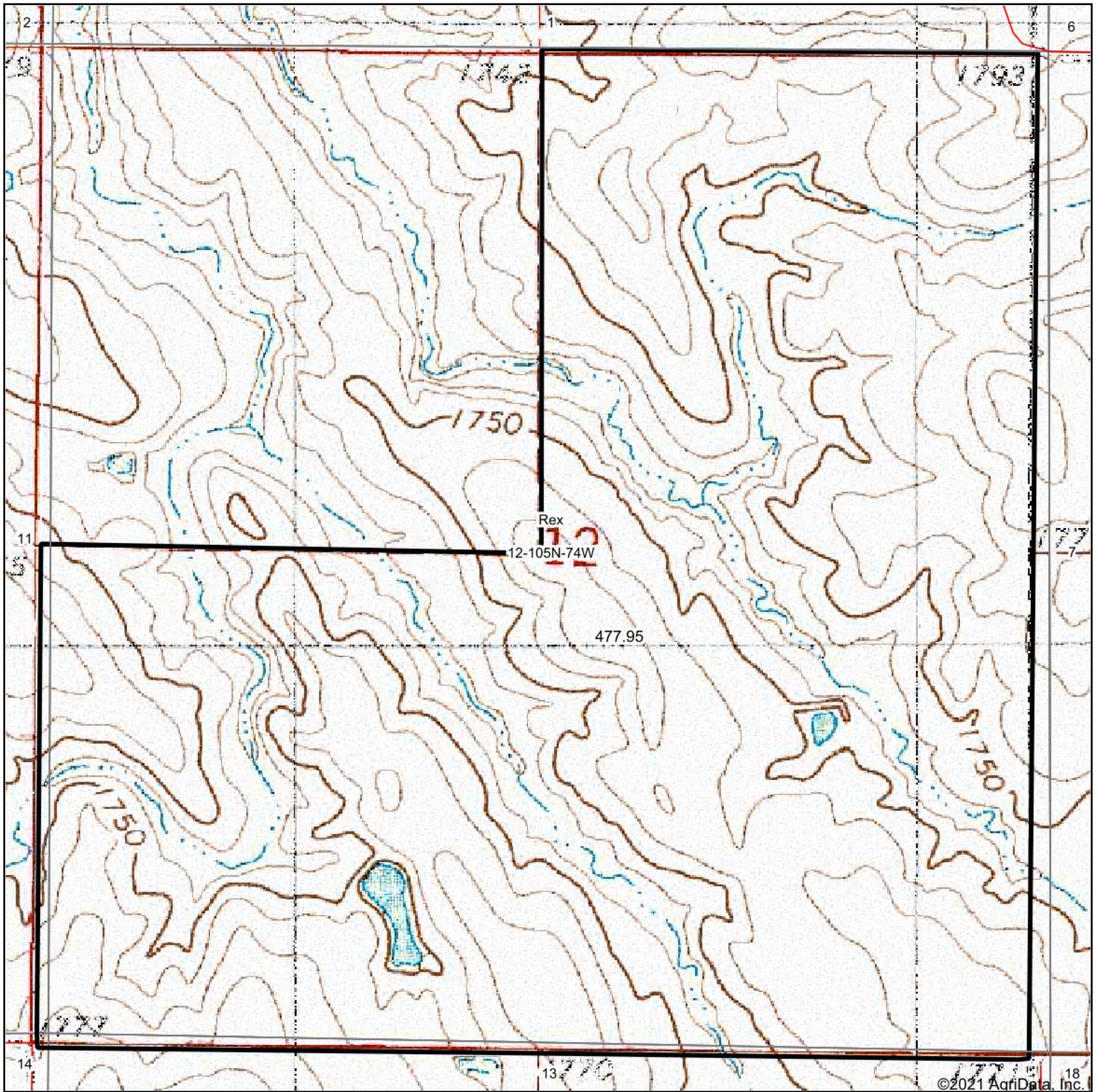

map center: 43° 54' 45.1, -99° 39' 19.56

0ft 820ft 1640ft

12-105N-74W
Lyman County
South Dakota

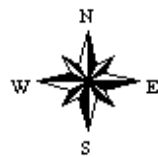

6/8/2021

Maps Provided By:



© AgriData, Inc. 2021 www.AgriDataInc.com